

Core Kuala Habitat area to be have minimal disturbance as a

Development shall be dog and cat free through use of title restrictions

Internal road speeds shall be a max. 10km/hr to minimise Koala road mortality

A monitoring program shall be developed and implemented to detects changes in Koala population over time & assess actual impacts from the proposed development

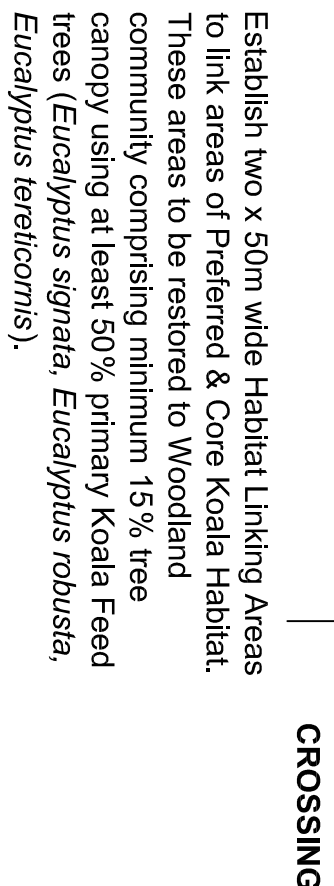

LEGEND

LEGEND

Existing Bushland proposed to be retained

Existing Trees to be retained

Existing Trees to be retained within proposed Koala Habitat Areas

Proposed Koala Tree plantings - primary feed trees e.g Swamp Mahogany (*Eucalyptus robusta*),

- secondary feed trees e.g. Bastard Tallowood (*E. planchoniana*), Broad leaved Paperbark (*Metaleuca quinquevneria*)

Traffic Calming Devices to facilitate Koala movement across perimeter access road

APZ Bushfire Zones



1800mm high security fencing



Planted landscape mounds to road frontage to soften & screen development

Scale: 1:1500 @ A1 1:3000 @ A3	Job Ref No.: 488101L01B
Drawing No.: 1 of 1	
Drawn by: C Matheson	
Design by: C Matheson	
Date Issued: 8.4.09	

The stated scale of this drawing may be altered by copying. The scale should be verified prior to deriving measurements from the drawing

Drawn by: C Matheson
Date Issued: 8.4.09

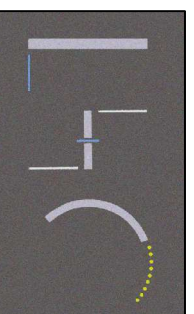
LUKE & COMPANY PTY LTD
Consultants in the Development of Land & Property
98 William St, PORT MACQUARIE NSW 2444
Tel: (02)6583 2677 Fax: (02) 6584 0103
www.lukeandcompany.com.au



PLANS TO 23/02/2009

- A. Administration and Reception Building
- B. General Store
- C1. Swimming Pool
- C2. Gymnasium
- D. Tennis Courts
- E. Bowling Green
- F. Bowling Clubhouse/Community Building
- G. Tennis Clubhouse/Library
- H. Fire Station
- I. Desalination Plant & 2000KL Reservoir
- J. Nursery
- K. Effluent Treatment Plant
- L. Caravan & Boat Storage
- M. Staff Facilities, Male & Female Change Rooms, Showers, WC

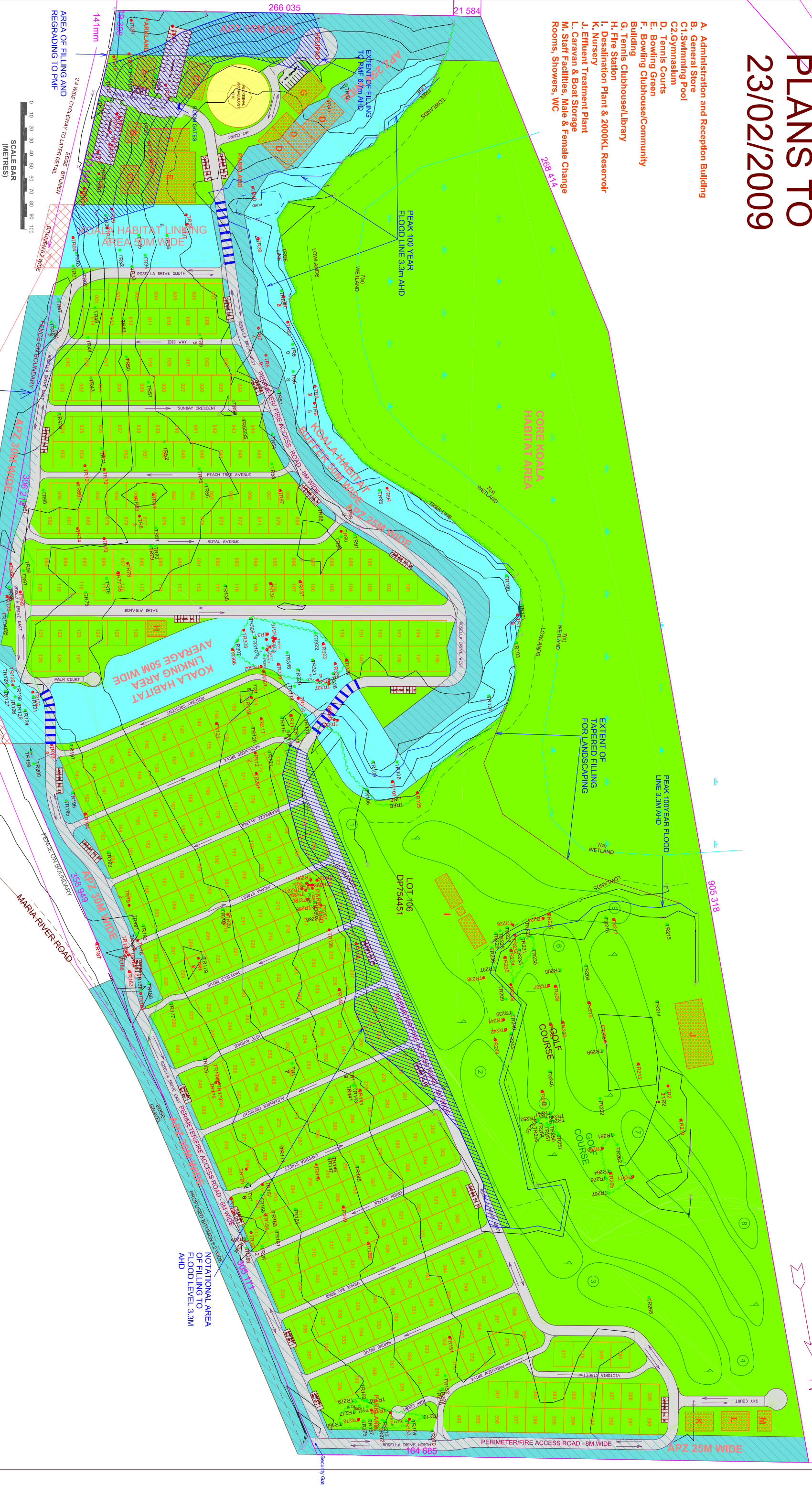

LEGEND

Traffic Calming Devices + Signage

REAL PROPERTY DESCRIPTION

LOT No 106 DP 75441

PART LOT No 91 DP 75441

PART LOT No 6 DP251919

PART LOT No 1 DP 114288

PARCELS 31072,37041 & 51149

PARISH OF TORRENS COUNTY OF MACQUARIE

SITE AREA 50.59 HECTARES

DATE		AMMENDMENTS	
5/1/09	Koala habitat, Site Setbacks,	<div> <div> MACQUARIE GARDENS SITE PLAN LOT 106 DP 754451 </div> <div> DATUM AHD PAGE SIZE A0 841mm X 1189mm </div> </div>	
6/1/09	Redesign of House Blocks		
8/1/09	Amendments to Site Layout		
23/2/09	Security Gates		